

57101 NeoSpeed

Aluminium - Mushroom head
3.2 mm (1/8") - 4.8 mm (3/16")

Speed fasteners with a unique splined rivet design combine high clamp throughout a wide grip range



Features

- Delivers a throughput up to four times greater than traditional threaded or breakstem fasteners
- Multi-grip capability accommodates wide variations in material thickness
- One rivet can be used to replace several standard grip fasteners
- External splines fill rear sheet and oversize front sheet holes
- 3x greater hole size tolerance than standard breakstem rivets
- Far less sensitive to application variations
- Easier specification due to one-rivet x one mandrel solution
- Typically half the installed weight versus an equivalent breakstem rivet
- Supply options: paper magazine of fasteners or preloaded disposable mandrel (cartridge)

Material

- Aluminium alloy (5% Mg), natural

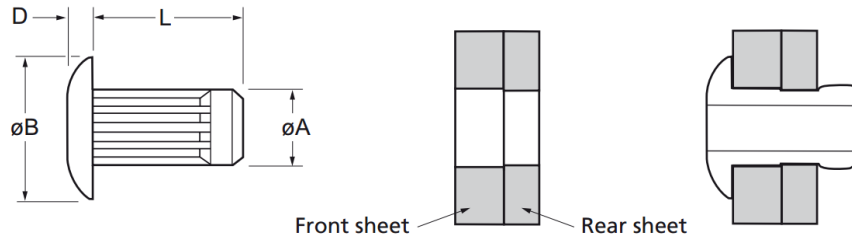

Part No.	Size ø	Grip Range		Front Sheet Hole Size		Rear Sheet Hole Size		øB	D	L	øA	Fasteners per pod ± 1	Shear (typical) kN	Tension (typical) kN
		min.	max.	min.	max.	min.	max.							
57101-03204	3.2 (1/8")	0.4	2.0	3.35	3.62	3.26	3.42	6.53	1.10	4.8	3.17	52	0.76	1.25
57101-03207			4.5							7.3		37		
57101-03211			8.6							11.5		24		
57101-04005	4.0 (5/32")	0.5	2.2	4.10	4.43	3.97	4.18	8.18	1.25	5.4	3.90	47	1.19	1.90
57101-04007			5.0							8.0		33		
57101-04011			9.1							11.7		23		
57101-04805	4.8 (3/16")	0.6	2.4	5.00	5.40	4.85	5.10	9.71	1.50	5.8	4.79	44	1.66	2.90
57101-04808			5.2							8.9		30		
57101-04812			9.2							12.7		22		

57101 NeoSpeed "Cartridge" Series

NeoSpeed® "Cartridge":
Pre-loaded disposable mandrel

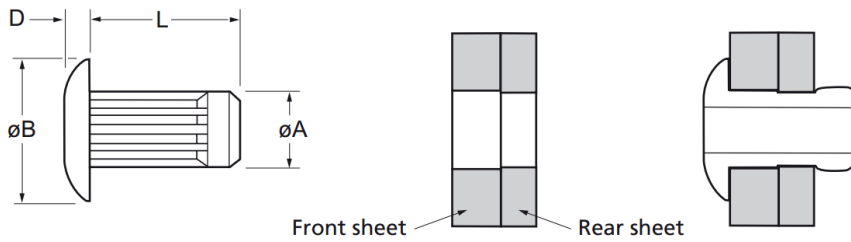
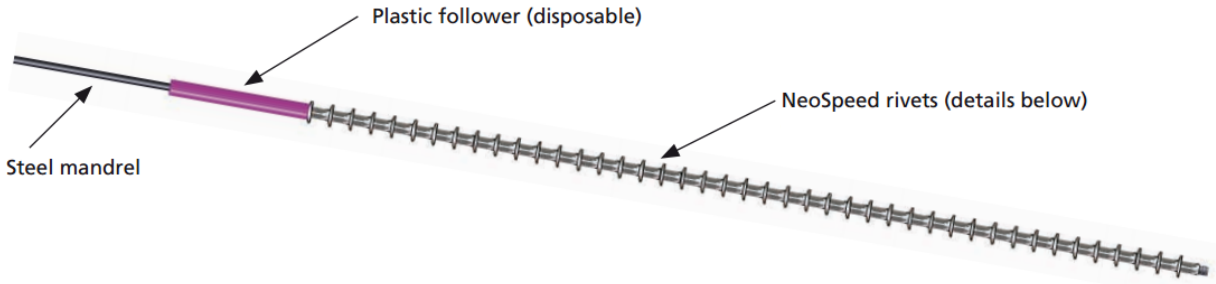

Part No.	Size ø	Grip Range		Front Sheet Hole Size		Rear Sheet Hole Size		øB max.	D max.	L max.	øA max.	Fasteners per pod ± 1	Shear (typical) kN	Tension (typical) kN	
		min.	max.	min.	max.	min.	max.								
57101-13204	3.2 (1/8")	0.4	2.0	3.35	3.62	3.26	3.42	6.53	1.10	4.8	3.17	52	0.76	1.25	
57101-13207			4.5							7.3					37
57101-13211			8.6							11.5					24
57101-14005	4.0 (5/32")	0.5	2.2	4.10	4.43	3.97	4.18	8.18	1.25	5.4	3.90	47	1.19	1.90	
57101-14007			5.0							8.0					33
57101-14011			9.1							11.7					23
57101-14805	4.8 (3/16")	0.6	2.4	5.00	5.40	4.85	5.10	9.71	1.50	5.8	4.79	44	1.66	2.90	
57101-14808			5.2							8.9					30
57101-14812			9.2							12.7					22

Assembly Applications

- Automotive
- Electronics
- Domestic appliances
- Electrical equipment
- General lighting fabrication



We are proud to be Avdel's authorized distributor of over 30 years